

Technical Data Sheet



10/23 - V1.0

20-M8BRTF

SIUTEC MK8 PREMIUM Nozzle - 1.75mm Brass Teflon coated (PTFE)

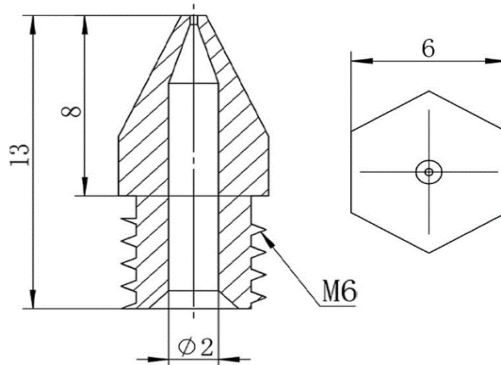

Features

Low Friction: Teflon's signature characteristic is its extremely low coefficient of friction, which can potentially facilitate smooth filament flow.

Chemical Resistance: Highly resistant to many chemicals, reducing the risk of reactions with exotic filaments.

Non-Stick Surface: Reduces the likelihood of filament adhesion and clogging.

Lightweight: Teflon is lighter than metals, reducing wear on printer movement systems.

Electrical Insulation: Excellent insulator, which might be of interest for niche applications.

Printer List

Creality Ender 3, Creality ender 5, Creality Ender 6, Creality Sermoon, Creality Cr-10S, Creality CR-6 SE, Creality CR6, Tronxy X5SA, Tronxy Xy2, Anet A8, Anet ET4, Creality Ender 2, Creality Ender 7

Product Specifications

Filament diameter	1.75mm
Nozzle diameter	0.2mm / 0.4mm / 0.6mm
Size	13x6mm
Thread	M6
Material	Brass Teflon Coated (PTFE)
Tolerance	± 0.01mm
Maximum Printing Temperature	270°C
Hardness (Mohs)	5,9
Thermal Conductivity	240 W/mK
Expansion Coefficient	12 µm/m*T

Applicable Materials

PLA, PLA+, ABS, TPU, PA, etc