

## Technical Data Sheet



10/23 - V1.0

20-V56BRT

### SIUTEC V5/V6 PREMIUM Nozzle - 1.75mm Brass Teflon coated (PTFE)

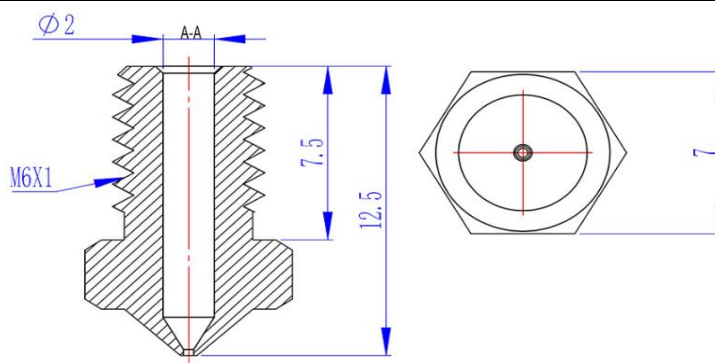

## Features

**Low Friction:** Teflon's signature characteristic is its extremely low coefficient of friction, which can potentially facilitate smooth filament flow.

**Chemical Resistance:** Highly resistant to many chemicals, reducing the risk of reactions with exotic filaments.

**Non-Stick Surface:** Reduces the likelihood of filament adhesion and clogging.

**Lightweight:** Teflon is lighter than metals, reducing wear on printer movement systems.

**Electrical Insulation:** Excellent insulator, which might be of interest for niche applications.

## Printer List

Prusa i3, Anycubic i3 Mega S, Anycubic Chiron, Anycubic 4MAX, Anycubic Vyper, Anycubic Kobra, Anycubic Kobra Max, E3D V5 Hotend, E3D V6 Hotend

## Product Specifications

Filament diameter	1.75mm
Nozzle diameter	0.25mm / 0.4mm / 0.6mm
Size	12.5x7mm
Thread	M6
Material	Brass Teflon Coated (PTFE)
Tolerance	± 0.01mm
Maximum Printing Temperature	270°C
Hardness (Mohs)	5,9
Thermal Conductivity	240 W/mK
Expansion Coefficient	12 µm/m*T

## Applicable Materials

PLA, PLA+, ABS, TPU, PA, etc