

# Technical Data Sheet



10/23 - V1.0

20-V560TI

## SIUTEC V6 PREMIUM Nozzle - 1.75mm Titanium Alloy

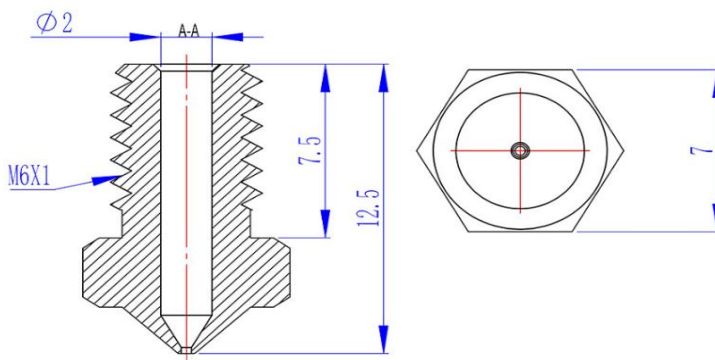

### Features

- Superior Durability:** Highly resistant to wear, even with abrasive filaments.
- Low Thermal Conductivity:** Maintains consistent temperatures, though heats up slower.
- Corrosion Resistant:** Exceptionally durable in varied environments, including corrosive settings.
- Lightweight:** Less strain on printer's movement systems.
- Biocompatibility:** Suitable for medical and dental applications due to non-reactivity.
- High Melting Point:** Can withstand extremely high temperatures without deformation.

### Printer List

Prusa i3, Anycubic i3 Mega S, Anycubic Chiron, Anycubic 4MAX, Anycubic Vyper, Anycubic Kobra, Anycubic Kobra Max, E3D V5 Hotend, E3D V6 Hotend

### Product Specifications

Filament diameter  
Nozzle diameter  
Size  
Thread  
Material  
Tolerance  
Maximum Printing Temperature  
Hardness (Mohs)  
Thermal Conductivity  
Expansion Coefficient

1.75mm  
0.3/0.4/0.5/0.6/0.8/1.0/1.2/1.5mm  
12.5x7mm  
M6  
Titanium Alloy  
± 0.01mm  
800°C  
x > 9  
6,4 W/mK  
10 µm/m\*T

### Applicable Materials

PLA, PLA+, ABS, TPU,PA,PEEK,PEI,Carbon Fiber,Fiberglas,Wood Fiber, Metallfber